

SAE butt welding reducing adaptor for split-flanges
 Collet SAE réduit bout à bout pour demi brides
 SAE Reduzierschweissadapter für Flanschälften

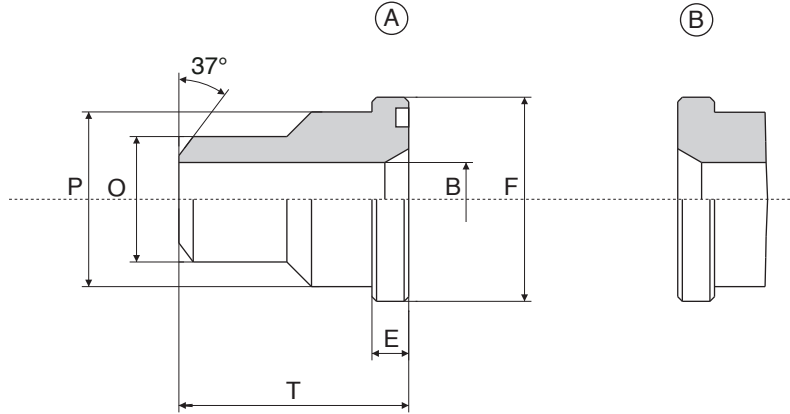

La massima pressione d'esercizio indicata in catalogo è basata sulla connessione a flangia.
 La pressione di esercizio del sistema completo è determinata dallo spessore del tubo e dal materiale del tubo .

The maximum recommended working pressure is based on the flange.
 The working pressure of the system is determined by the tube (thickness) and by the steel quality of the tube .

Serie 3000 psi

Pressione max esercizio bar	Tipo Type	Size	B	E	F	P	O	T	OR O-RINGS
348	CR.3018-ST	1/2"	10	6,7	30,2	24	18	45	4075
348	CR.3022-ST	3/4"	13	6,7	38,1	31,5	22	50	4100
348	CR.3028-ST	1"	19	8	44,4	38	28	55	4131
287	CR.3035-ST	1" 1/4	25	8	50,8	43	35	60	4150
210	CR.3043-ST	1" 1/2	31	8	60,3	50	43	65	4187
210	CR.3050-ST	2"	38	9,5	71,4	62	50	70	4225
175	CR.3062-ST	2" 1/2	47	9,5	84,1	74	62	75	4275
138	CR.3076-ST	3"	58	9,5	101,6	90	76	85	4337
35	CR.3090-ST	3" 1/2	70	11,2	114,3	102	90	90	4387
35	CR.3102-ST	4"	88	11,2	127	114	102	100	4437

Serie 6000 psi

Pressione max esercizio bar	Tipo Type	Size	B	E	F	P	O	T	OR O-RINGS
420	CR.6018-ST	1/2"	10	7,7	31,8	24	18	45	4075
420	CR.6022-ST	3/4"	13	8,7	41,3	32	22	50	4100
420	CR.6028-ST	1"	18	9,5	47,6	38	28	55	4131
420	CR.6035-ST	1" 1/4	22	10,3	54	44	35	60	4150
420	CR.6044-ST	1" 1/2	29	12,5	63,5	51	44	65	4187
420	CR.6051-ST	2"	35	12,5	79,4	67	51	70	4225

Per ordinare coduli:

How to order straight adaptors:

Pour commander collet:

Bestellbeispiel für Gerade Adapteren:

CR.....ST A Con sede OR / With OR groove / Avec OR gorge / Mit Or Nut
 CR.....ST B Senza sede OR / Without OR groove/ Sans OR gorge / Ohne Or Nut