

ISO 6164 - '94 Closed adaptors
 Collets d'obturation ISO 6164 - '94
 ISO 6164 - '94 Verschluss Stopfen

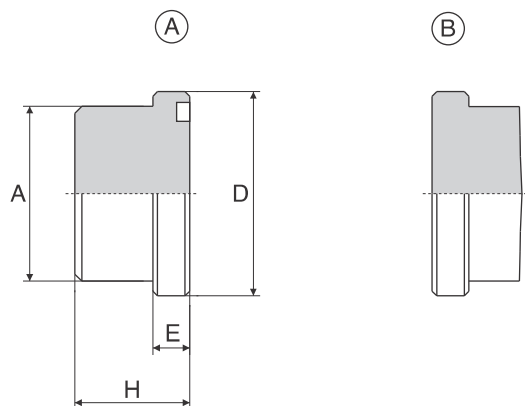

Serie 250 bar

| Pressione max esercizio bar | Tipo Type | DN | Size | D | E | A | H | OR O-RING |
|-----------------------------|------------|----|--------|-------|------|------|------|-----------|
| 250 | 64.L.10.O | 10 | 3/8" | 24,5 | 6,8 | 18 | 18 | 3068 |
| 250 | 64.L.13.O | 13 | 1/2" | 30,2 | 6,8 | 24 | 20 | 4075 |
| 250 | 64.L.19.O | 19 | 3/4" | 38,1 | 6,8 | 31,5 | 22 | 4100 |
| 250 | 64.L.25.O | 25 | 1" | 44,5 | 8 | 38 | 25 | 4131 |
| 250 | 64.L.32.O | 32 | 1" 1/4 | 50,8 | 8 | 43 | 30 | 4150 |
| 250 | 64.L.38.O | 38 | 1" 1/2 | 60,4 | 8 | 50 | 36 | 4187 |
| 250 | 64.L.51.O | 51 | 2" | 71,4 | 9,6 | 62 | 40 | 4225 |
| 250 | 64.L.56.O | 56 | 2" 1/2 | 87,2 | 12 | 76 | 45 | 4275 |
| 250 | 64.L.63.O | 63 | 3" | 101,6 | 15 | 90 | 52 | 4337 |
| 250 | 64.L.80.O* | 80 | 4" | 131 | 23,5 | 114 | 61,5 | 6387 |

*: non prevista da ISO 6164 - '94 / Not in ISO 6164 - '94

Serie 400 bar

| Pressione max esercizio bar | Tipo Type | DN | Size | D | E | A | H | OR O-RING |
|-----------------------------|-----------|----|--------|------|------|-----|----|-----------|
| 400 | 64.S.10.O | 10 | 3/8" | 26 | 7,8 | 18 | 18 | 3068 |
| 400 | 64.S.13.O | 13 | 1/2" | 31,8 | 7,8 | 24 | 20 | 4075 |
| 400 | 64.S.19.O | 19 | 3/4" | 41,3 | 8,8 | 32 | 22 | 4100 |
| 400 | 64.S.25.O | 25 | 1" | 47,6 | 9,5 | 38 | 25 | 4131 |
| 400 | 64.S.32.O | 32 | 1" 1/4 | 54 | 10,3 | 44 | 30 | 4150 |
| 400 | 64.S.38.O | 38 | 1" 1/2 | 63,5 | 12,6 | 51 | 36 | 4187 |
| 400 | 64.S.51.O | 51 | 2" | 79,4 | 12,6 | 67 | 40 | 6225 |
| 400 | 64.S.56.O | 56 | 2" 1/2 | 94,2 | 16,5 | 80 | 50 | 6275 |
| 400 | 64.S.63.O | 63 | 3" | 104 | 18 | 90 | 52 | 6300 |
| 400 | 64.S.70.O | 70 | 3" 1/2 | 119 | 20 | 102 | 60 | 6337 |
| 350 | 64.S.80.O | 80 | 4" | 131 | 23,5 | 114 | 70 | 6350 |

Per ordinare coduli
 How order straight adaptors
 Example pour commander collets
 Bestellbeispiel für gerade adaptoren

Es.: 64.....OA
 Es.: 64.....OB